

Overview

This guide will help you register, log-in and access the Iowa State University Dependent Review site. If you have concerns, please contact WTW Dependent Verification Center at 1-855-722-9663 between 8 a.m. and 5 p.m. (CST), Monday through Friday.

Creating an Account

Navigate to the Dependent Review site to log-in. The log-in page is where you can provide your details to access the site. Click 'Create Account.'

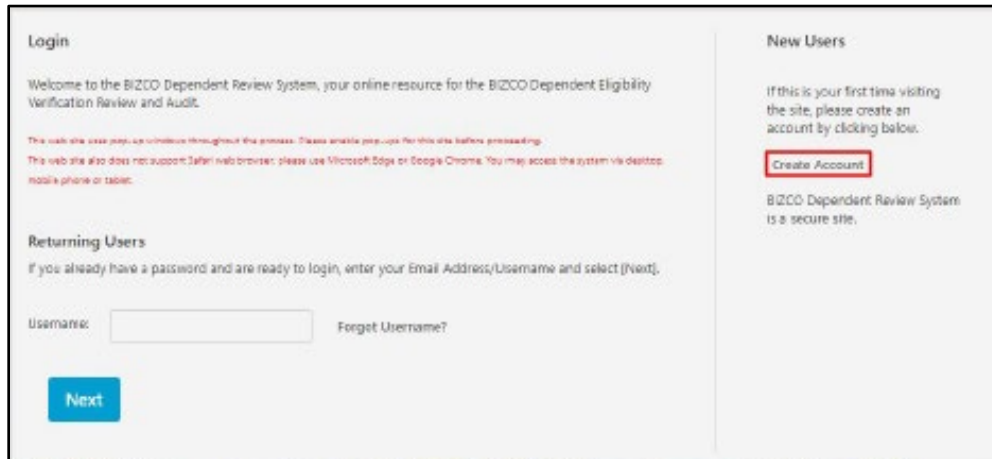

The screenshot shows the login page for the BIZCO Dependent Review System. It is divided into two main sections: 'Login' and 'New Users'.
Login Section:
- Title: 'Login'
- Welcome message: 'Welcome to the BIZCO Dependent Review System, your online resource for the BIZCO Dependent Eligibility Verification Review and Audit.'
- Browser warning: 'This web site uses pop-ups windows throughout the process. Please enable pop-ups for this site before proceeding. This web site also does not support Safari web browser; please use Microsoft Edge or Google Chrome. You may access the system via desktop, mobile phone or tablet.'
- 'Returning Users' section: 'If you already have a password and are ready to login, enter your Email Address/Username and select [Next].'
- Username field: A text input box labeled 'Username:' with a 'Forgot Username?' link to its right.
- 'Next' button: A blue button at the bottom left.
New Users Section:
- Title: 'New Users'
- Instruction: 'If this is your first time visiting the site, please create an account by clicking below.'
- 'Create Account' button: A red-bordered button with the text 'Create Account'.
- Note: 'BIZCO Dependent Review System is a secure site.'

It will then take you to the page where you will need to enter information to identify yourself further. This information will also be used if you will need to reset your password.

You can identify yourself by using either your ISU email address, employeeID or Social Security Number on the registration page. Steps for each of those options are as follows:

Register Using Email Address

If you choose using Email address, you will need to provide your ISU email address, last 4 digits of your SSN, and birth date.



The screenshot shows the 'Tell Us About Yourself' registration page. It asks for personal information to identify the user.
- Title: 'Tell Us About Yourself'
- Instruction: 'Please provide the following information to tell us who you are.'
- Question: 'Do you know your Email?'
- Radio buttons: 'Yes' (selected) and 'No'.
- Fields: Three text input boxes labeled 'Email:', 'Last 4 Digits of Your SSN:', and 'Birth Date (MM/DD/YYYY):'.
- Buttons: 'Cancel' and 'Next' buttons at the bottom.

Once you have provided correct details, a code will then be sent to the ISU email you have provided. Go to the inbox of your email address and look for the email sent by WTW. The emails should look like the screenshots below.

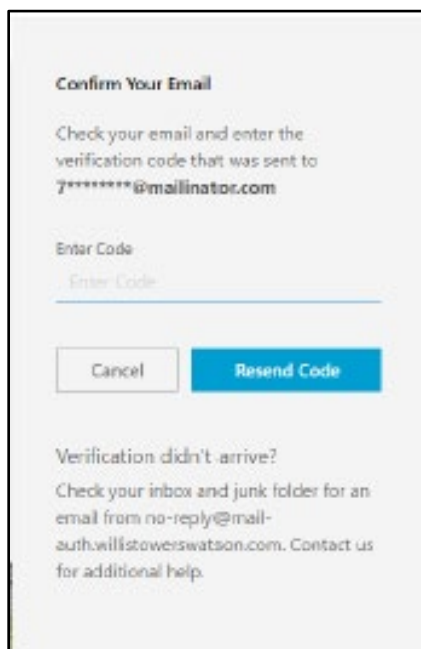
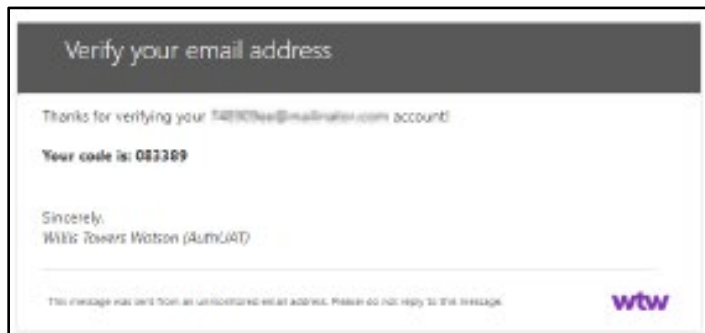

Once you have provided a correct code, you will need to enter a phone number so that the system can confirm your identity. Click on 'Send Code' and wait for the text message with the code and enter the code in the next screen. You can also click on 'Call Me' and you will receive a phone call.

Enhanced Security

Enter a number below that we can send a code via text message or call you to confirm your identity.

Country Code

Philippines (+63) ▼

Phone Number

9153000058

Cancel Send Code

Call Me

Text Message Verification

Enter the verification code you received.

Enter Code

Enter Code

Cancel Resend Code

Once you've entered the verification code, you will then need to provide a password. Follow the password requirements to create a valid password.

Create Password

Password must be at least 8 characters long and contain at least 3 of the following:

- uppercase letters
- lowercase letters
- numbers
- symbols

New Password

New Password

Confirm New Password

Confirm New Password

Cancel Submit

After you've created your password, you will then be directed to the online authorization page below. If you've seen this page, then you have successfully created your account. Click 'Accept' to access the homepage.

Online Authorization

Please read the following information. At the bottom of the page indicate whether you accept or decline the terms by clicking the appropriate button.

On behalf of my eligible dependent(s), I agree to and understand the following:

1. I certify that any dependents enrolled under any coverage are eligible dependents under the terms of the Plan.
2. Any material omission or misrepresentation in answering the questions in this system may result in the denial of benefits, termination of coverage and enrollment for me and my dependents and/or corrective action.
3. I understand that in all cases, if there is any discrepancy between information made available through this Web site and benefits which may be provided pursuant to the official B2CD Plan (the "Plan") provisions, the Plan document will govern. B2CD (the "Company") and any subsidiaries reserve the right to amend, modify, or terminate any Plan(s) without notice to the extent permitted by law. Further, all rights and limitations detailed in the Plan(s) is/are subject to change at any time.

By clicking the Accept button below, I understand that this action will serve as my electronic signature and that by law this electronic signature will have the same effect as a signature on a paper form.

Decline

Accept